

271
Socket, right and left hand thread, ISO/EN M2 R-L

RT ... right hand thread, LT ... left hand thread

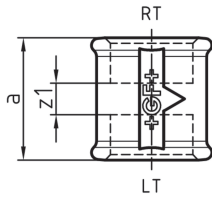

	EN Dim. (inch)	Black Code	Galvanised Code	a (mm)	z1 (mm)
•	3/8	770 271 103	770 271 203	30	10
•	1/2	770 271 104	770 271 204	36	10
•	3/4	770 271 105	770 271 205	39	9
•	1	770 271 106	770 271 206	45	11
•	1 1/4	770 271 107	770 271 207	50	12
•	1 1/2	770 271 108	770 271 208	55	17
-	2	770 271 109	770 271 209	65	17